

# ROBERTS

Sound for Generations

## MP-16

CD AM/FM RDS/DAB digital sound system  
with MP3 and remote control

**MP-SOUND 16**



Please read this manual before use **DAB** Digital Audio Broadcasting

## Contents

<i>MP-16 Sound features</i> .....	2	<i>Display modes - FM RDS</i> .....	22
<i>Controls</i> .....	3-5	<i>FM Stereo/Mono</i> .....	22
<i>Remote handset battery replacement</i> .....	6	<i>Operating your radio - Search tuning MW</i> .....	23
<i>Connecting the AM loop aerial</i> .....	6	<i>Manual tuning - FM and MW</i> .....	24
<i>Connecting the loudspeakers</i> .....	7	<i>Presetting stations</i> .....	26
<i>Mains operation</i> .....	8	<i>Equalizer function</i> .....	27
<i>Setting the clock</i> .....	9	<i>Mute function</i> .....	27
<i>Using your system for the first time</i> .....	10	<i>Sleep function</i> .....	28
<i>Selecting the MP-16 modes</i> .....	11	<i>Compact discs</i> .....	29-33
<i>Operating your radio - DAB</i> .....	12	<i>MP3 CD mode</i> .....	33-36
<i>Selecting a station - DAB</i> .....	13	<i>Alarm</i> .....	37-41
<i>Secondary services - DAB</i> .....	13	<i>System reset</i> .....	42
<i>Display modes - DAB</i> .....	14	<i>Clock display</i> .....	43
<i>Finding new stations - DAB</i> .....	15	<i>Headphone and optical output sockets</i> .....	44
<i>Signal strength display - DAB</i> .....	15	<i>Line level Input socket</i> .....	45
<i>Manual tuning - DAB</i> .....	16	<i>Line level Out socket</i> .....	45
<i>Station order setup - DAB only</i> .....	17	<i>General</i> .....	46
<i>Prune stations - DAB only</i> .....	18	<i>Specifications</i> .....	46
<i>Software version - DAB only</i> .....	18	<i>Mains supply</i> .....	47
<i>Dynamic Range Control (DRC) settings - DAB only</i> .....	19	<i>Notes</i> .....	48-49
<i>Operating your radio - Search tuning FM</i> .....	20	<i>Guarantee</i> .....	50
<i>Automatic programme type search - FM</i> .....	21		

## **MP-16 Sound System features**

The Roberts MP-16 Sound system provides the following features in an attractive compact unit.

### **Radio**

The MP-16 can receive DAB, FM (with RDS), and AM (Medium Wave) bands.

### **CD**

The MP-16 plays audio CDs (can also play CDR, CDRW discs)

### **CD-MP3**

The MP-16 plays MP3 files which have been recorded to CDR or CDRW

### **Line level input**

The MP-16 can be used as an amplifier and loudspeaker system for external MP3 players, mini disc players and similar devices.

### **Line level output**

A line-level output is provided for optional connection to other audio equipment.

### **Headphone output**

A standard 3.5mm headphone socket is provided for private listening.

### **Digital output**

An optical output is provided for connection to AV receivers, mini-disc recorders or other devices with a digital input.

### **High quality power supply**

High quality mains power supply features a toroidal mains transformer for low stray magnetic fields and high efficiency.

## Controls

(Front)

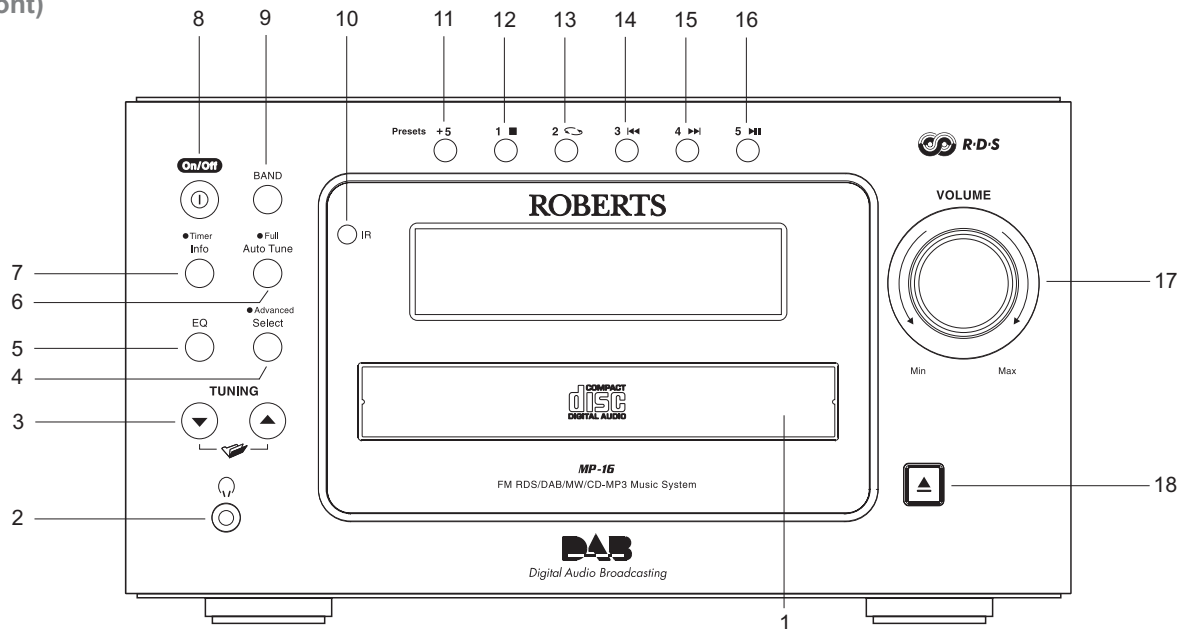

1. CD compartment
2. Headphone socket
3. Tuning Up or Down buttons
4. Select button
5. Equalizer button
6. Auto-tune button

7. Timer / Info button
8. On/Off button
9. Band / Source button
10. Infra-red sensor
11. Preset +5 button
12. Preset 1 / Stop button

13. Preset 2 / Repeat button
14. Preset 3 / Rewind button
15. Preset 4 / Fastforward button
16. Preset 5 / Pause/Play button
17. Volume control
18. CD Eject button

## Controls

(Rear)

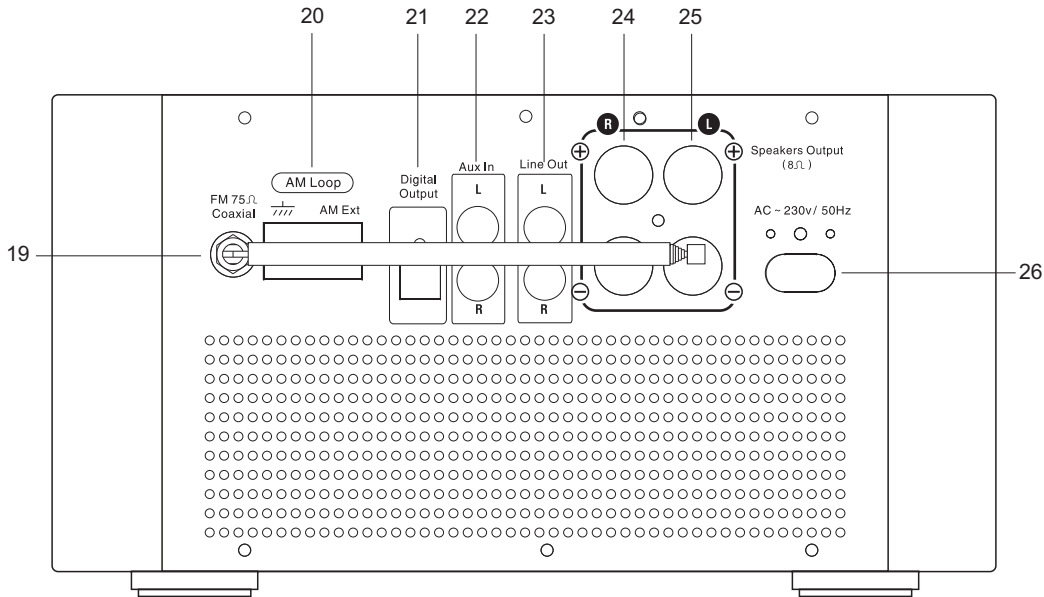

- 19. DAB/FM Telescopic aerial (socket F-type)
- 20. AM Loop aerial socket
- 21. Optical output socket (Toslink)
- 22. Auxilliary input sockets

- 23. Line output sockets
- 24. Right speaker output
- 25. Left speaker output
- 26. AC mains input socket

If you need any further advice, please call our Technical Helpline on :-  
020 8758 0338 (Mon-Fri)

## Remote control

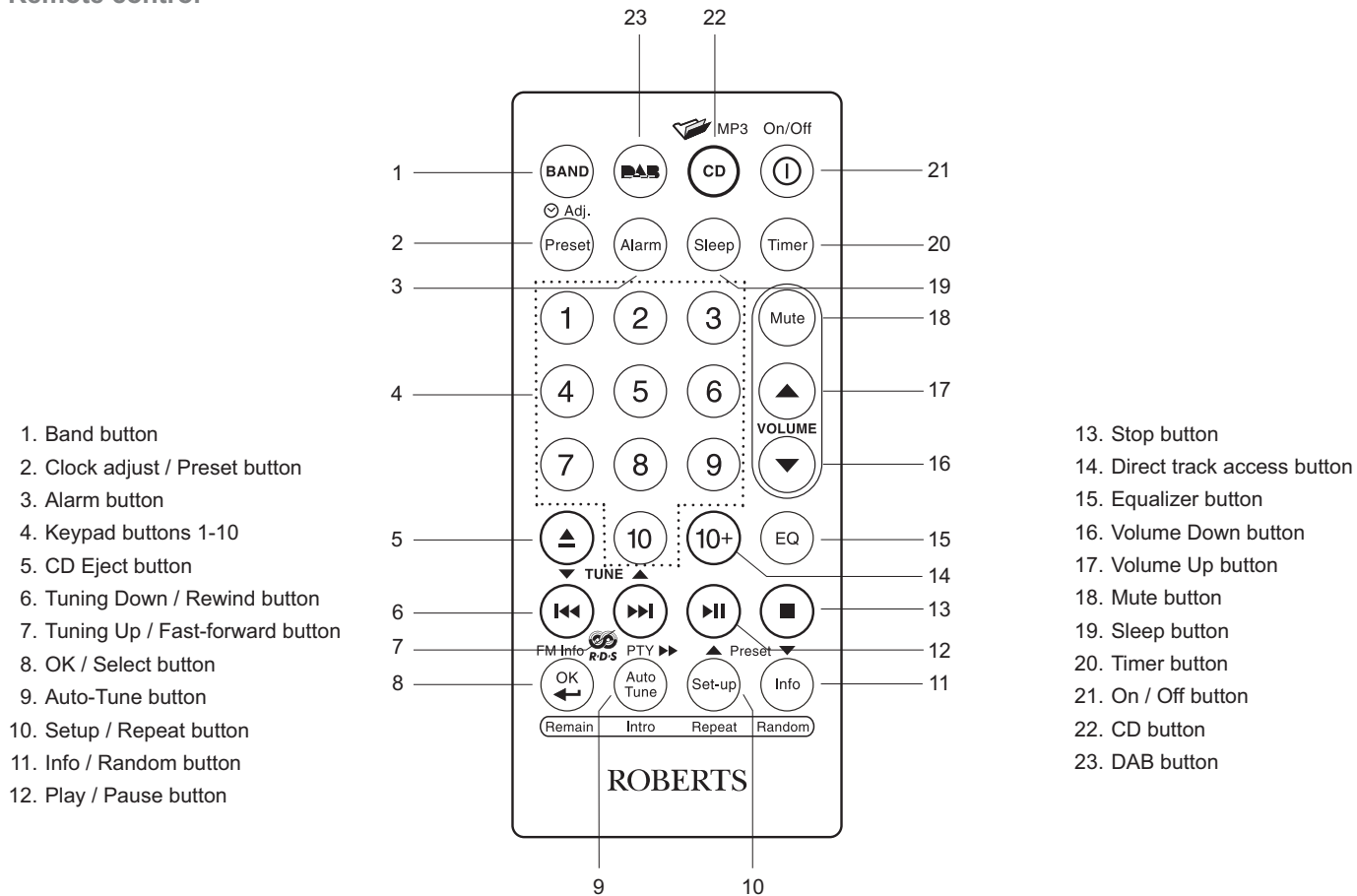

## Remote handset battery replacement

1. Press in the tab on the left hand side of the battery tray and slide the tray out.
2. Remove battery holder by pushing holder in direction shown.
3. Remove battery from holder.
4. Replace battery (CR2025 or equivalent) ensuring that the positive side of the battery faces you with holder positioned as shown.
5. Replace the battery holder.

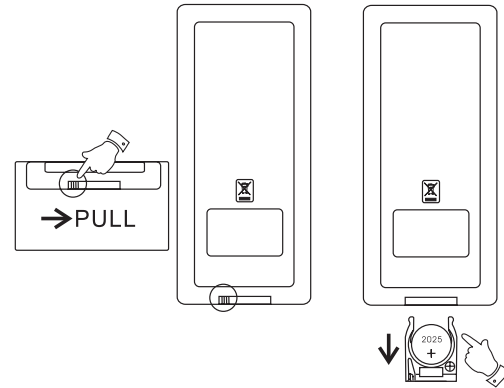

## Connecting AM loop aerial

For AM (medium wave) radio listening it is necessary to connect the AM loop antenna which is supplied with your unit. Press down the two plastic tabs on the AM loop antenna socket on the back of the main unit. Carefully insert the two bare ends of the wire into the holes and then lift the tabs back up to secure the wires.

The placement of the antenna may need to be adjusted according to the direction and strength of the signal from the desired AM radio station. Try to place the antenna away from direct sources of interference (e.g. computer monitors, light dimmers, etc). You may need to rotate the antenna for optimum reception.

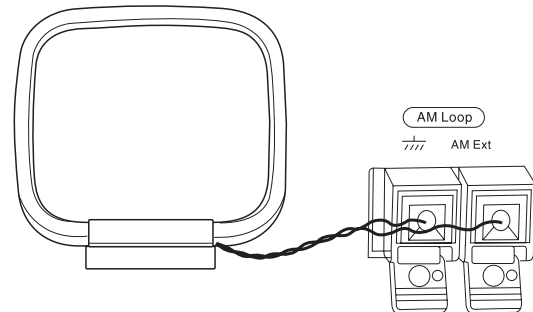

## Connecting loudspeakers

The loudspeakers should be connected using the cable supplied as shown. The two loudspeakers are identical. One loudspeaker should be placed in front of and to the left of the normal listening position, and the other in front of and to the right.

It is important for good bass reproduction and stereo location that both speakers are wired in the same phase with respect to the amplifier outputs. This can be done as follows. The **red terminal** on the back of the amplifier marked **R** and + should be connected to the **red terminal** of the right-hand loudspeaker. The **black terminal** marked **R** and - should be connected to the **black terminal** of the right-hand loudspeaker. Using the other piece of speaker cable, connect the terminals marked **L +** and **L -** to the **red** and **black** terminals of the left hand speaker. The cable supplied uses two different colours of wire to help you make these connections. Use one colour for the red terminals and the other for the black.

The placement of the loudspeakers will depend upon the layout of the room. Location is not critical, but do not place them in direct sunlight or over sources of heat such as radiators. Optimum sound quality will result if they are to be placed slightly away from any corners, and with each loudspeaker an equal distance from the normal listening position and pointing towards the listener.

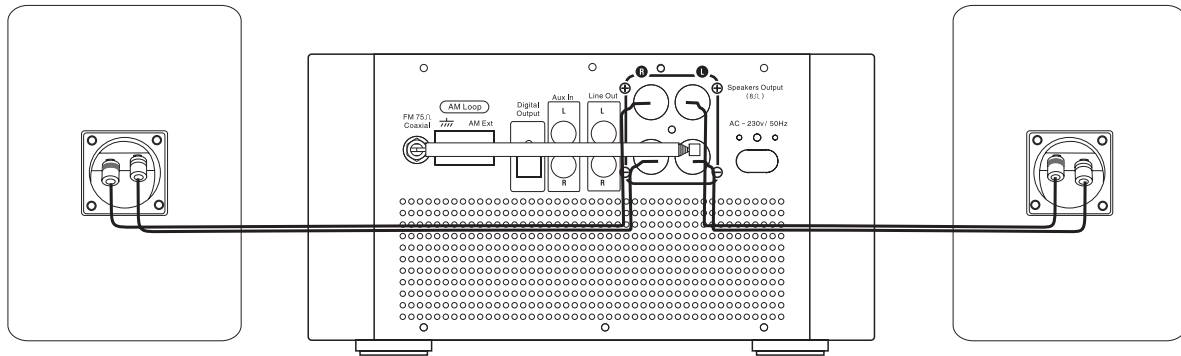



## Mains operation

Before connecting the mains, ensure that the loudspeakers and any other audio components are connected. Please disconnect the mains supply before making any changes to the audio connections.

1. Place your sound system on a flat surface.
2. Plug the mains lead into the **Socket** located on the rear of your radio ensuring that the plug is pushed fully into the socket.
3. Plug the other end of the mains lead into a wall socket and switch on the wall socket.
4. The clock digits on the display will flash.
5. To set the clock refer to page 9.

**Please note the time must be set before the alarm function can be used.**

- The mains plug is used to connect your apparatus to the AC mains supply. In order to completely disconnect the apparatus from the AC mains supply, the mains plug should be removed from the mains socket outlet.

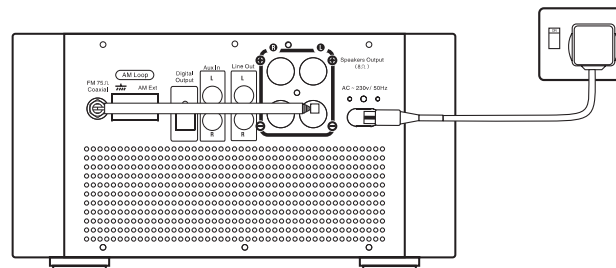

Please note: The instructions for the MP-16 are described firstly using the remote control (**highlighted in bold**) and secondly using the front panel [*highlighted with brackets*].

## Setting the clock

Leave the unit in Standby while the clock sets. In the event that the clock does not automatically set follow the procedure below.

You will need to set the clock before the alarm function can be set. The clock display will be 24hr format.

1. Press and hold the **Clock adjust button** [*Press and release the Select button on front panel*], the hour digits on the display will flash.
2. Press the **Tuning Up or Down buttons** until the desired hour digit is set.
3. Press and release the **Clock adjust button** [*Press and release the Select button on front panel*], the minute digits on the display will flash.
4. Press the **Tuning Up or Down buttons** until the desired minute digit is set. If the button is held down the digits will change more quickly.
5. Press the **Clock adjust button** [*Press and release the Select button on front panel*] to confirm the clock setting.

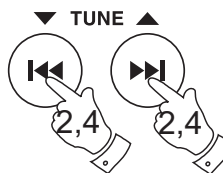
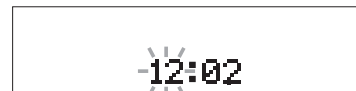
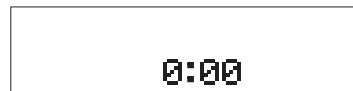

## Using your system for the first time

1. Fully extend the telescopic aerial.
2. Press the **On/Off button** [Standby on front panel] to switch on your sound system.
3. If this is the first time the sound system is used the display will show "FM" and will enter FM mode. If the sound system has been used before the last used mode will be selected.

On/Off

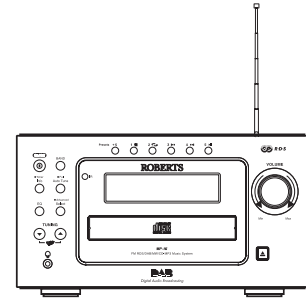

## Selecting the MP-16 modes

### To select DAB

1. Press and release the **DAB button** [*Band / Source button on front panel*] the unit will enter the DAB mode. See page 12.

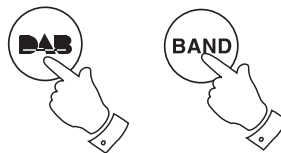

BBC 7  
Just a Minute...

### To select CD

1. Press and release the **CD button** [*Band / Source button on front panel*] the unit will enter the CD mode. See page 29.



Tr 1 0.00

### To select FM/MW

1. Press and release the **Band button** [*Band / Source button on front panel*] the unit will enter the FM or the MW mode. See page 20, 23.



TUNER

### To select Auxiliary

1. Press and release the **Band button** [*Band / Source button on front panel*] until "Aux" shows on the display and the unit will enter Auxiliary mode. See page 45.



AUX

## Operating your radio - DAB

1. Fully extend the telescopic aerial located on the rear of your sound system.
2. If your sound system is in standby mode, press the **On/Off button** [*Standby button on front panel*] to switch on your system.
3. Press and release the **DAB button** [*Repeatedly press the Band/Source button on the front panel*]. The display will show "Welcome to digital radio" for a few seconds.
4. If this is the first time the radio is used a quick scan of UK Band III DAB channels will be carried out. The display will show "Scanning". If the radio has been used before the last used station will be selected.
5. During auto-tune new stations are detected and will be added to the list.
6. When the Auto-tune is complete the first station (in numeric-alpha order 0...9...A...Z) will be selected.
7. If the station list is still empty after the Auto-tune your radio will display "No Stations available".
8. If no signals are found it may be necessary to relocate your radio or aerial to a position giving better reception.

In some cases an external aerial may be desirable for optimal DAB reception. This can be connected to the F-type connector on the rear of the unit in place of the supplied telescopic antenna.

On/Off



Welcome to  
Digital Radio

Scanning... 24  
■■■■■■■■■■

Now tuning...

BBC 7  
Just a Minute...

No stations  
available

## Selecting a station - DAB

1. The top line of the display shows the name of the station currently selected.
2. Press the **Up or Down Tuning buttons** to scroll through the list of available stations. Stop pressing the **Tuning buttons** when you find the station that you wish to hear.
3. Press and release the **OK/Select button** [Select button on front panel] to select the station. The display may show "Tuning" while your radio finds the new station.
4. Adjust the **Volume** to the required settings.

Note: If after selecting a station the display shows "Station not available" it may be necessary to relocate your unit to a position giving better reception. You may also see this message if the station is not broadcasting at the time.

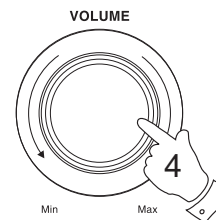
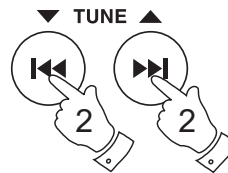

## Secondary services - DAB

1. Certain radio stations have one or more secondary services associated with them. If a station has a secondary service associated with it the display will show ">>" next to the station name on the station list. The secondary service will then appear immediately after the primary service as you press the **Tuning Up button**.
2. Press and release the **OK/Select button** [Select button on front panel] to select the station.



## Display modes - DAB

Your radio has seven display modes:-

1. Press the **Info button** to cycle through the various modes.

- |                        |   |
|------------------------|---|
| a. Scrolling text      | Displays scrolling text messages such as artist/track name, phone in number, etc. |
| b. Programme type      | Displays type of station being listened to e.g. Pop, Classic, News, etc.          |
| c. Multiplex Name      | Displays name of multiplex to which current station belongs.                      |
| d. Time and date       | Displays current time and date.   |
| e. Channel & frequency | Displays channel number and frequency.  |
| f. Bit rate/audio type | Displays the digital bit rate and audio type.                                     |
| g. Signal error        | Displays signal error for station being listened to.                              |



- |   |                           |
|---|---------------------------|
| a | BBC 7<br>Just a Minute... |
| b | BBC 7<br>Culture          |
| c | BBC 7<br>BBC National     |
| d | BBC 7<br>19:17 08-06-2005 |
| e | BBC 7<br>11C 220.35 MHz   |
| f | BBC 7<br>128kbps Stereo   |
| g | BBC 7<br>■■■■■□■■■■       |

## Finding new stations - DAB

As time passes new stations may become available. To find new stations proceed as follows:-

1. Press and release the **Auto-tune button**, the display will show "Scanning". Your radio will perform a scan of the UK DAB frequencies. As new stations are found the station counter on the right-hand side of the display will increase and stations will be added to the list.
2. To carry out a full scan of the entire DAB Band III frequencies press and hold down the **Auto-tune button** for more than 2 seconds and then release. The display will show "Scanning". As new stations are found the station counter on the right-hand side of the display will increase and stations will be added to the list.



---

## Signal strength display - DAB

The different DAB information displays include a signal strength indicator. This display can also be accessed directly without changing the DAB information type.

1. Press and release the **OK/Select button** [Select button on front panel] the lower line of the display shows signal strength. Position your radio and angle the telescopic aerial for best reception using the signal strength display as a guide. Move your system around and position so as to give maximum number of black rectangles on signal strength display.
2. The clear unfilled rectangle indicates minimum signal level required for satisfactory reception. Press and release the **OK/Select button** [Select button on front panel] to return to normal tuning mode. In some cases an external aerial may be desirable for optimal DAB reception.





## Manual Tuning - DAB

Manual tuning allows you to tune directly to the various DAB Band III channels. UK DAB stations are located in the range 11B to 12D.

1. Press and release the **Setup button** [Press and hold the Select button on the front panel] until the display shows "Station order".
2. Press the **Tuning Up or Down buttons** until "Manual tune" appears on the display. Press and release the **OK/Select button** [Select button on front panel].
3. Press the **Tuning Up or Down buttons** to select the required DAB channel.
4. Press and release the **OK/Select button** [Select button on front panel] to select the channel.
5. Any new stations that are found are automatically added to the stored list of stations.
6. Press and release the **OK/Select button** [Select button on front panel] to return to normal tuning mode.

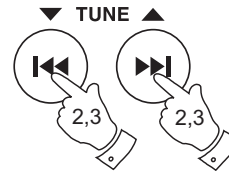

◆ ◆ or SELECT  
◆ Station order ◆

◆ ◆ or SELECT  
◆ Manual tune ◆

◆ 11C 220.35 MHz ◆

■■■■■  
11C EMAP SY

## Station order setup - DAB only

Your sound system has 3 station order settings from which you can choose. The station order settings are, favourite station, alphanumeric and active station.

Note: Your radio default station order is alphanumeric.

1. Press and release the **Setup button** [Press and hold the Select button on the front panel] until "Station order" appears on the display. Press the **OK/Select button** [Select button on front panel] to enter setup.
2. Press the **Tuning Up or Down buttons** to choose between favourite station, alphanumeric and active station.
3. Press and release the **OK/Select button** [Select button on front panel] to select the station order setting required.

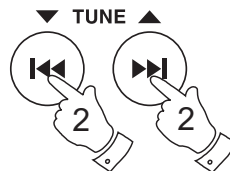
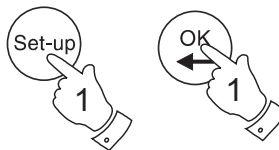

## Favourite stations

When this setting is switched on, after a period of time the most listened to stations will move to the top of the station list and will be marked with the heart symbol ♥.

## Alphanumeric

Press the **Tuning Up and Down buttons** until "Alphanumeric" appears on the display. Your radio will now select stations in alphanumeric order A...Z 0...9.

## Active station

Press the **Tuning Up or Down buttons** until "Active station" appears on the display. The display will show only those that a signal can be found.

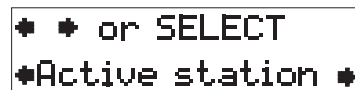

## Prune stations - DAB only

Some DAB services may stop broadcasting or you may not be able to receive a station. Prune stations will delete the DAB stations from your station list that can no longer be received.

1. Press and release the **Setup button** [Press and hold Select button on front panel] until "Station order" appears on the display. Press and release the **OK/Select button** [Select button on front panel] .
2. Press the **Tuning Up or Down buttons** until "Prune stations" appears on the display.
3. Press and release the **OK/Select button** [Select button on front panel] to select.



```
◆ ◆ or SELECT
◆ Station order ◆
```

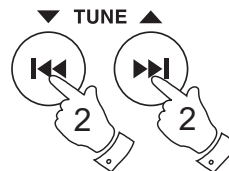

```
◆ ◆ or SELECT
◆ Prune station ◆
```

---

## Software version - DAB only

The software display cannot be altered and is for your reference only.

1. To view the software version your radio has, press and release the **Setup button** [Press and hold the Select button on the front panel] until "Station order" appears on display.
2. Press the **Tuning Up or Down buttons** until "Software version" appears on the display. The software version will appear on the display.



```
◆ ◆ or SELECT
◆ Station order ◆
```

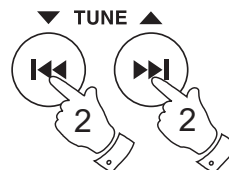

```
◆ U.131.19-8
◆ Sw Version ◆
```

## Dynamic Range Control (DRC) settings - DAB only

DRC can make quieter sounds easier to hear when your radio is used in a noisy environment. This function is only for the DAB waveband.

1. Press the **On/Off button** [*Standby button on front panel*] to switch on your sound system.
2. Press and release the **Setup button** [*Press and hold the Select button on the front panel*] until "Station order" appears on the display.
3. Press and release the **Tuning Up and Down buttons** until the display shows "DRC value".
4. Press and release the **OK/Select button** [*Select button on front panel*] to enter adjustment mode.
5. Press and release the **Tuning Up or Down buttons** to select required DRC setting (default is 1).
  - DRC 0 DRC is switched off, Broadcast DRC will be ignored.
  - DRC 1/2 DRC level is set to 1/2 that sent by broadcaster.
  - DRC 1 DRC is set as sent by broadcaster.
6. Press and release the **OK/Select button** [*Select button on front panel*] to confirm the setting. The display will return to radio mode.

On/Off

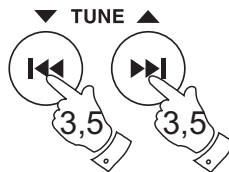

◆ ◆ or SELECT  
◆ Station order ◆

◆ ◆ or SELECT  
◆ DRC value ◆

DRC0  
◆ DRC0 ◆

DRC0  
◆ DRC 1/2 ◆

DRC0  
◆ DRC 1 ◆

## Operating your radio - Search tuning FM

1. Fully extend the telescopic aerial.
2. Press the **On/Off button** [Standby button on front panel] to switch on your sound system.
3. Press and release the **Band button** [Band / Source button on front panel] until the FM band is selected.
4. Press and hold the **Tuning Up button**, your radio will scan in an upwards direction (low frequency to high frequency) and stop automatically when it finds a station of sufficient strength.
5. After a few seconds the display will update. If the FM band is selected the display will show the station name if available.
6. To find other stations press and hold the **Tuning Up button** as before.
7. To scan the FM band in a downwards direction (high frequency to low frequency) press and hold down the **Tuning Down button** for 0.5 seconds and then release.
8. When the waveband end is reached your radio will recommence tuning from the opposite waveband end.
9. Adjust the **Volume** to the required settings.
10. To switch off your radio press the **On/Off button** [Standby button on front panel].

On/Off

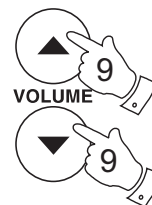
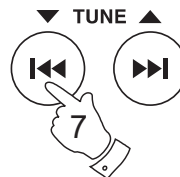
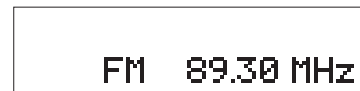
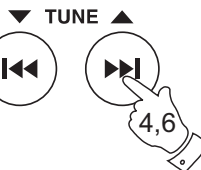

On/Off



## Automatic programme type search - FM

Your sound system can automatically search for a programme type such as news, sport etc. and will tune in to a station transmitting this information.

1. Fully extend the telescopic aerial.
2. Press the **On/Off button** [Standby button on front panel] to switch on your sound system.
3. Press and release the **Band button** [Band / Source button on front panel] to select the FM band.
4. Press and release the **Auto-tune button**, the radio will enter the programme type mode. The first programme type available will show on display.
5. Press and release the **Auto-tune button** until the required programme type shows on the display.
6. To begin the programme type search press and hold down either the **Tuning Up or Down buttons** for 0.5 seconds. The radio will scan the FM band until it finds a station transmitting your required programme type.
7. If a programme of the specified type is not found the radio will tune to the previously selected station and will show "NO MATCH".
8. To switch off your radio press the **On/Off button** [Standby button on front panel].

On/Off



PTY >>



▼ TUNE ▲

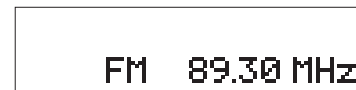
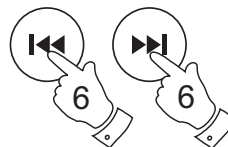

On/Off



## Display modes - FM RDS

Your system has four display modes in FM. The Radio Data System (RDS) is a system in which inaudible digital information in addition to the normal FM radio programme is transmitted.

On FM the bottom line of the display can be set to any of the following modes.

1. Press the **OK/Select button** [*Info button on the front panel*] to cycle through the various modes.
  - a. Station Name Displays the station name currently being transmitted
  - b. Programme Type Displays type of station being listened to e.g. Pop, Classic, News, etc.
  - c. Radio Text Displays radio text messages such as news items etc.
  - d. Frequency Displays frequency of the station being listened to.



Note: When tuned to the FM band, information display is only available when the radio is able to receive RDS information from the broadcaster.

---

## FM Stereo/Mono

1. If a station is being received with a weak signal some hiss may be audible. To reduce the hiss press and release the [*Select button on front panel*] until the display shows "Mono". Your radio will switch to mono mode.
2. To return to stereo mode press and hold in the [*Select button on front panel*] until the display shows "Auto". Your radio will switch to stereo mode.

● Advanced Select



## Operating your radio - Search tuning MW

1. For MW the unit uses the external loop antenna. Position and rotate the loop antenna for best reception.
2. Press the **On/Off button** [Standby button on front panel] to switch on your sound system.
3. Press and release the **Band button** [Band/Source button on front panel] to select MW band. The display will show the MW Tuner.
4. Press and immediately release the **Tuning Up button**, your radio will scan in an upwards direction (low frequency to high frequency) and stop automatically when it finds a station of sufficient strength.
5. After a few seconds the display will update.
6. To find other stations press and release the **Tuning Up button** as before.
7. To scan the MW band in a downwards direction (high frequency to low frequency) press and hold down the **Tuning Down button** for 0.5 seconds and then release.
8. When the waveband end is reached your radio will recommence tuning from the opposite waveband end.
9. Adjust the **Volume** to the required settings.
10. To switch off your radio press the **On/Off button** [Standby button on front panel].

On/Off

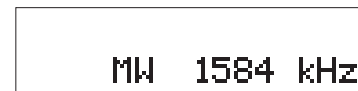
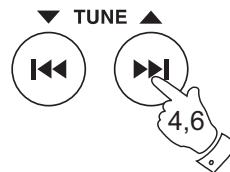

On/Off





## Manual tuning - FM and MW

1. Press the **On/Off button** [Standby button on front panel] to switch on your sound system.
2. Press and release the **Band button** [Band/Source button on front panel] to select the FM or MW band. Fully extend the **telescopic aerial** for FM reception. For MW the unit uses the external loop antenna. Position and rotate the loop antenna for best reception.
3. Press the **Tuning Up and Down buttons** to tune to a station. The frequency will change in steps of 50kHz on FM. On MW the frequency will change in steps of 9 kHz.
4. When the waveband end is reached the radio will recommence tuning from the opposite waveband end.
5. Set the **Volume** to the desired settings.
6. To switch off your radio press the **On/Off button** [Standby button on front panel].

On/Off

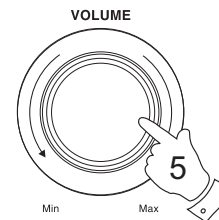
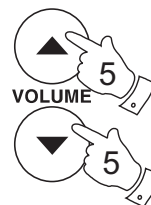
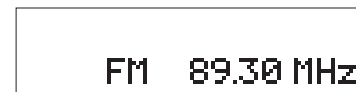
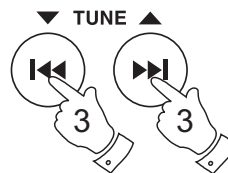

On/Off



## Presetting stations - DAB

There are 10 memory presets for the DAB.

1. Press the **On/Off button** [Standby button on front panel] to switch on your sound system.
2. Tune to the required station as previously described.
3. Press and hold down the required **Preset button** (1 to 10) until the display shows e.g. "Preset 1 stored". The station will be stored under the chosen preset button. Repeat this procedure for the remaining presets.
4. Stations stored in preset memories may be overwritten by following the above procedure.

On/Off

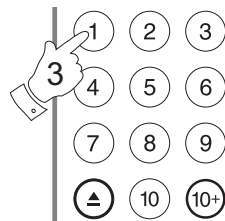

BBC R2  
Preset 1 saved

## Presetting stations - FM and MW

There are 10 memory presets on each of the MW and FM wavebands.

1. Press the **On/Off button** [Standby button on front panel] to switch on your sound system and tune to the required station as previously described.
2. Press and release the **Clock Adjust/preset button**.
3. Press and hold down the required **Preset button** (1 to 10) until the display shows e.g. "Ch 1". The station will be stored under the chosen preset button. Repeat this procedure for the remaining presets.

On/Off



Adj.

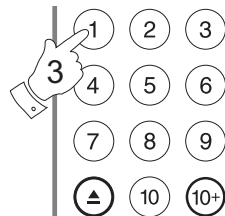

CH  
1 FM 89.30 MHz

- Stations stored in preset memories may be overwritten by following the above procedure.

## Presetting stations (using front panel)

- Press and hold down the required preset button (1-5) on the front panel.
- To store presets 6 -10 press and release the +5 Preset button then press and hold the required preset button. ie. Preset 1 will then be used to store preset 6.

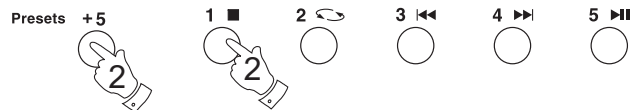
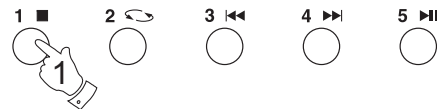

## Recalling a preset station (all wavebands)

- Press the **On/Off button** [Standby button on front panel] to switch on your sound system.
- Select the required waveband by pressing the **DAB or Band button** [Band/Source button on front panel].
- Momentarily press the required **Preset button** (1-10), your radio will tune to the station stored in preset memory.

Note: If you have not previously stored a preset station and the preset button is pressed "Empty preset" will be displayed.

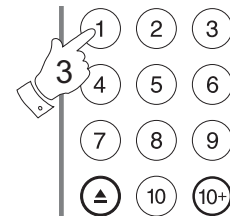

BBC 2  
BBC National

## Equalizer function

The tone on your sound system can be adjusted to suit the particular broadcast listened to or according to personal preferences. Your sound system has five equalizer modes:-

1. Press the Equalizer button to cycle through the various modes.
  - a. Flat
  - b. Jazz
  - c. Rock
  - d. Classic
  - e. Pop



FLAT

JAZZ

ROCK

CLASSIC

POP

---

## Mute function

Pressing the Mute button on the remote control will mute the output from the loudspeakers.

1. Press the **Mute button** to mute sound output.
2. Press **Mute again** to return to normal play mode.



MUTE

## Sleep function

Your sound system can be set to turn off after a preset time has elapsed. The sleep setting can be adjusted between 10 and 90 minutes in 10 minute increments.

1. To set the desired sleep time, press the **Sleep button** to enter the sleep setup. "Sleep" will appear on the display.
2. Repeatedly press and release the **Sleep button** to select the desired sleep time 90>80>70>60>50>40>30>20>10 minutes or to OFF to permanently cancel the sleep function.
3. Your sound system will switch off after the preset sleep time has elapsed.
4. To cancel the sleep function before the preset time has elapsed, press the **On/Off button** [Standby button on front panel].



On/Off



## Compact discs

Use only Digital Audio CDs which have the  symbol.

Never write on a CD or attach any sticker to the CD. Always hold the CD at the edge and store it in its box after use with the label facing up.

To remove dust and dirt, breathe on the CD and wipe it with a soft, lint free cloth in a straight line from the centre towards the edge.

Cleaning agents may damage the CD.

Do not expose the CD to rain, moisture, sand or to excessive heat. (e.g from heating equipment or in motor cars parked in the sun).

## CD-R/CD-RW discs

Your MP-16 can playback CD-DA format audio CD-R/CD-RW discs that have been finalised\* upon completion of recording.

Your MP-16 may fail to playback some CD-R/CD-RW discs due to poor recording and wide variation in quality of the CD-R/CD-RW disc.

\*Finalising enables a CD-R/CD-RW disc to playback on audio players such as your MP-16.

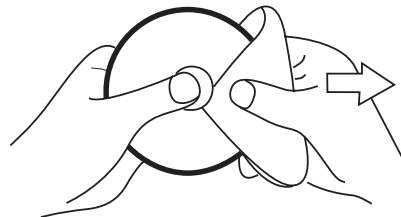

## Inserting a CD

Ensure the cd tray is empty before inserting a CD. Press the **Cd/Eject button** to ensure the unit is empty.

1. To select the CD mode press the **CD button** [Band/Source button on the front panel].
2. To eject or load a CD press and release the **CD Eject button**.
3. To insert an audio CD, place printed side facing up into the cd compartment. Press and release the **CD Eject button** to close the cd compartment. The unit will check the CD type and load its track list. The display will show "Reading".
4. If you load a CD with MP3 tracks your sound system will enter the MP3 mode see page 33.



## Playing a CD

1. Press the **Play/Pause button** to start playback. The display will show the first track number.
2. Adjust the **Volume** to the required settings.
3. To pause playback press the **Play/Pause button**. To resume playback press the **Play/Pause button** again.

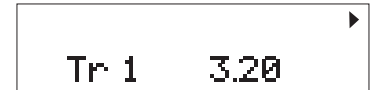

- To stop play, press the **Stop button**. The total number of CD tracks will be displayed.
- To take out the CD, press and release the **CD Eject button**. The display will show "Open".



## Selecting a track

- While the CD is playing, press either the **Fastforward** or **Rewind** buttons to change to the desired track, the track number appears in the display.
- You can also skip tracks when the player is in stop mode. Skip to the desired track using the **Fastforward** or **Rewind** buttons. Press and hold the button to make the track numbers cycle, release the button when the desired track is displayed.
- Press the **Play/Pause** button to play the selected track.

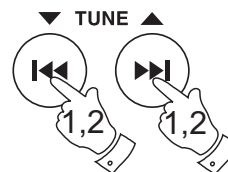
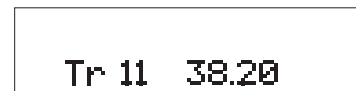

## Select a desired track

- For track numbers 1-9 simply press the corresponding digit button on the remote control.
- For track numbers ten and above press the **direct track access button** then press the required digits.
- If the track number entered exceeds the number of tracks on the CD, then no track will be played.

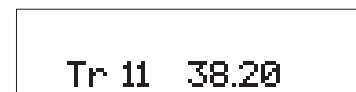
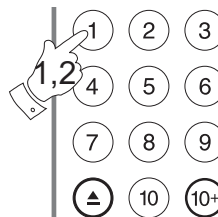



## Search function

1. While the CD is playing, press and hold the **Fastforward** or **Rewind** buttons.
2. Release the button when the desired part of the track is reached.

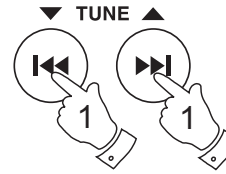

## Repeat a single track

1. While the CD is playing, press the **Setup** button [Preset 2/Repeat button on the front panel] until the single track symbol appears in the display. The current track will be repeated.

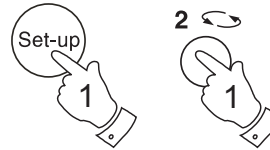

## Repeat all tracks

1. While the CD is playing, press the **Setup** button [Preset 2/Repeat button on the front panel] until the repeat all tracks symbol appears in the display. All the tracks will be repeated.

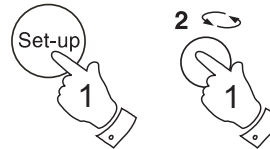

## Play tracks in random order

1. While the CD is playing, press the **Info** button until the random symbol appears in the display. The tracks will be played in random order.



## To stop playing tracks in random order

1. While the CD is playing, repeatedly press the **Info** button until the random symbol disappears from the display. The CD will return to normal play.



## CD Intro play

1. While the CD is in stop mode, press the **Auto-tune/Intro button** once to play the first 10 seconds of all the tracks on the CD.
2. Press the **Stop button** to interrupt Intro play.

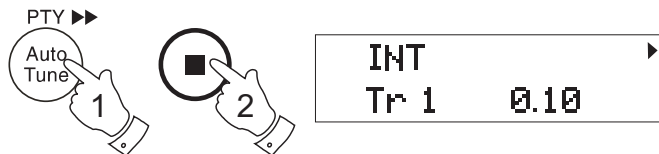

## CD time display

The button marked Remain **OK/Select button** allows different time information to be displayed for the CD or track currently being played. For each press and release of the **OK/Select button** will cycle through the following displays, time into current track, total time into CD, time remaining on current CD track and total time remaining on CD.

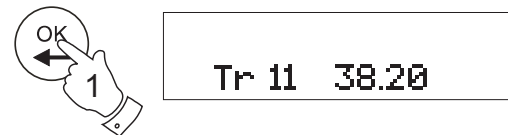

## MP3 CD Mode

1. To select the CD mode press the **CD button**.

The MP-16 is able to play CD-R and CD-RW discs containing MP3 files.

In MP3 mode the terms "album" and "file" are very important. "Album" corresponds to a folder on a PC, "File" to a PC or a CD -DA track. The device reads MP3 files with a maximum of 255 files per album. An MP3 CD may not contain more than 512 files or albums in total. MP3 files must be created with an audio sample rate of 44.1kHz (this is normal for files created from CD audio content).

When burning CD-R and CD-RWs with audio files, various problems may arise which could lead to interference in playback. This can be caused by faulty software or hardware settings or by the CD being used. Should such problems arise, contact the customer services of your CD burner or software manufacturer or look for relevant information, for example on the internet. When you are making audio CDs, observe all legal guidelines and ensure that the copyright of third parties is not infringed.



## Playing an MP3 CD

1. Press the **Play/Pause button** to start playback. The display will show the first track number.
2. Adjust the **Volume** to the required settings.
3. To pause playback press the **Play/Pause button**. To resume playback press the **Play/Pause button** again.
4. To stop play, press the **Stop button**. The total number of CD tracks will be displayed.
5. To take out the CD, press and release the **CD Eject button**. The display will show "Open".
6. Whilst the MP3 CD is playing repeatedly press the **OK/Select button** if you wish to view track information.

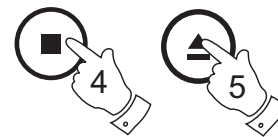

## Selecting a track

1. While the CD is playing, press either the **Fastforward** or **Rewind buttons** to change to the desired track, the track number appears in the display.
2. You can also skip tracks when the player is in stop mode. Skip to the desired track using the **Fastforward** or **Rewind buttons**. Press and hold the button to make the track numbers cycle, release the button when the desired track is displayed.
3. Press the **Play/Pause button** to play the selected track.

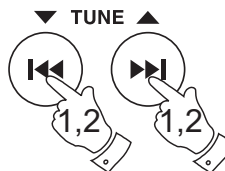

## Select a desired track

1. For track numbers 1-9 simply press the corresponding digit button.
2. For track numbers ten and above press the **direct track access button** then press the required digits.
3. If the track number entered exceeds the number of tracks on the CD, then no track will be played.

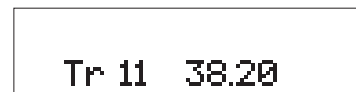
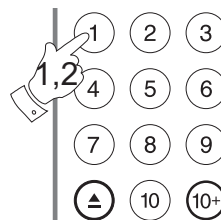
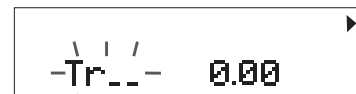

## Search function

1. While the MP3 CD is playing, press and hold the **Fastforward** or **Rewind buttons**.
2. Release the button when the desired part of the track is reached.

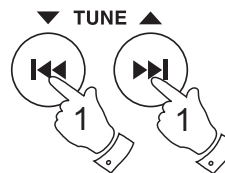

## To skip to the next folder

1. While the MP3 CD is in stop or play mode, press and release the **Folder button** [Tuning Up or Down buttons on front panel].
2. The first file of the next folder will be played.



(1)

## Repeat a single MP3 track

1. While the MP3 CD is playing, press the **Setup button** [Preset 2/Repeat button on front panel] until the single track symbol appears in the display. The current track will be repeated.

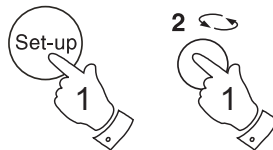

## Repeat all MP3 tracks

1. While the MP3 CD is playing, press the **Setup button** [Preset 2/Repeat button on front panel] until the repeat all tracks symbol appears in the display. All the tracks will be repeated.

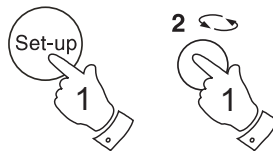

## Repeat all MP3 tracks in a single album

1. While the MP3 CD is playing, press the **Setup button** [Preset 2/Repeat button on front panel] until the repeat all tracks in a single album symbol appears in the display. All the tracks within that album will be repeated.

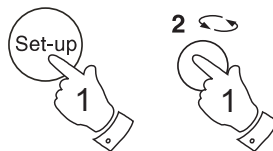

## Play tracks in random order

1. While the MP3 CD is playing, press the **Info button** until the random symbol appears in the display. The tracks will be played in random order.



## To stop playing files in random order

1. While the MP3 CD is playing, repeatedly press the **Info button** until the random symbol disappears from the display. The MP3 CD will return to normal play.



## Alarm

Your sound system has an alarm which can be set to wake you to CD, FM radio, MW radio, DAB or an external source connected to the line input.

1. Press and release the **Timer button** [Press and hold the Timer/info button on front panel] the clock time will show on the display. Ensure that the clock time is set see page 9.
2. Press and release the **Timer button** [Press and release the Timer/info button on front panel] again the alarm digits will show on the display and "On" will be displayed next to the alarm symbol.
3. Press and release the **Clock adjust button** [Press and release the Select button on the front panel] to adjust the alarm hour digits. The alarm hour digits will flash.
4. Press the **Tuning Up or Down** to select the required alarm hour.
5. Press and release the **Clock adjust button** [Press and release the Select button on the front panel] to adjust the alarm minute digits. The alarm minute digits will flash.
6. Press the **Tuning Up or Down** to select the required alarm minute.

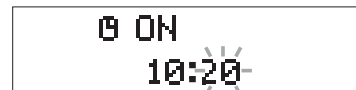
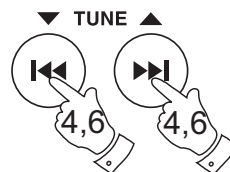
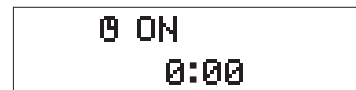
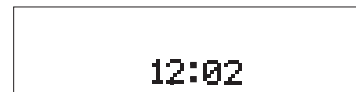

7. Press and release the **Timer button** [Press and release the *Timer/info button on the front panel twice*] the alarm turn off time will show on the display and "OFF" will be displayed next to the alarm symbol.



8. Press and release the **Clock adjust button** [Press and release the *Select button on the front panel*] to adjust the alarm turn off hour digits. The alarm hour digits will flash.



10. Press and release the **Clock adjust button** [Press and release the *Select button on the front panel*] to adjust the alarm turn off minute digits. The alarm turn off minute digits will flash.

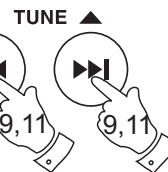

11. Press the **Tuning Up or Down buttons** to select the required alarm turn off minute.

12. Press and release the **Timer button** [Press and release the *Timer/info button on the front panel twice*] the previous alarm mode set will show on the display and "SOURCE" will be displayed next to the alarm symbol.



13. Press and release the **Clock adjust button** [Press and release the *Select button on the front panel*] to adjust the alarm mode.

14. Press the **Tuning Up or Down buttons** to select the required alarm mode.

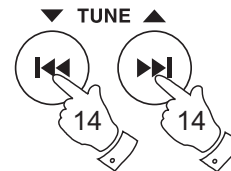

14. Your alarm can be set to the following modes:

CD - Will wake you from favourite CD

⊘ SOURCE  
CD

FM Tuner - Will wake you from FM radio station

⊘ SOURCE  
FM TUNER

AM Tuner - Will wake you from MW radio station

⊘ SOURCE  
MW TUNER

DAB - Will wake you from DAB radio station

⊘ SOURCE  
DAB

Aux - Will wake you from any source connected to the line input.

⊘ SOURCE  
AUX



15. Press and release the **Timer button** [Press and release the Timer/Info button on the front panel twice] the volume will show on the display.
16. Press and release the **Clock adjust button** [Press and release the Select button on the front panel] to adjust the volume level.
17. Press the **Tuning Up or Down buttons** to select the required volume level.
18. Press the **On/Off button** [Standby button on front panel] again and the radio will remain in standby mode until the alarm sounds. The alarm symbol  will appear in the display. If the alarm has been enabled. To enable the alarm if needed press and release the alarm button. (see page 41)

The alarm will sound at the selected alarm time.

**Note: The alarm will not sound if the alarm has not been activated and set to the "Enabled" position. See page 41.**

**When the alarm is set to wake by radio your sound system will switch on to the last used station.**

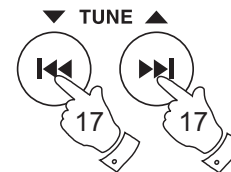
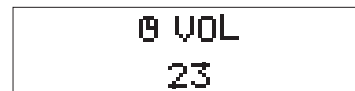

## Switching alarm on or off

1. To turn the alarm On (ENABLED) or Off (CANCEL) press and release the **Alarm button**.
2. The alarm symbol  will appear when the alarm has been enabled.

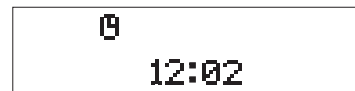

## Cancelling alarms

Note: The alarm will activate for the specified alarm duration (maximum 24 hours).

1. Press the **On/Off button** [*Standby button on front panel*] to switch the alarm off.
2. Enter the alarm setup menu and select the alarm mode to the "CANCEL" position.



## System reset

If your radio fails to operate correctly, or some digits on the display are missing or incomplete carry out the following procedure.

1. Ensure that your radio is in DAB mode.
2. Press and hold in the **Setup button** [Press and hold the Select button on the front panel] the display will show "Station order".
3. Press the **Tuning Up or Down buttons** until the display shows "Select factory reset". Press in and release the **OK/Select button** [Select button on front panel].
4. Press in and release the **OK/Select button** [Select button on front panel] to select System reset.
5. If DAB was used last then a "Quick scan" of the DAB band will be performed, otherwise a "Quick scan" will be carried out the next time the DAB band is selected.

After a system reset, any DAB preset settings will have been cancelled.

If a problem persists our technical staff would be pleased to help offer any assistance on operating the radio. Our technical helpline number is 020 8758 0338.



◆ ◆ or SELECT  
◆ Station order ◆

Press SELECT to  
confirm reset...



Scanning... 24  
■■■■■■■■■■

BBC 7  
Now tuning...

BBC 7  
Just a Minute...

## Clock display

1. Your radio will display clock time when it is set to Standby mode.

On/Off

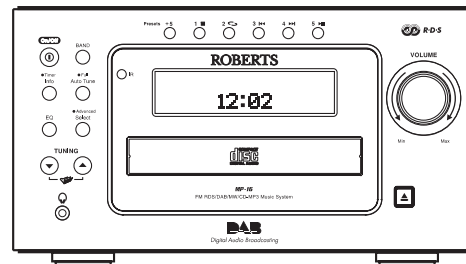

## Headphone and optical output sockets

1. A 3.5mm **Headphone Socket** located on the front of your system is provided for use with headphones. Inserting a plug automatically mutes the internal loudspeaker.

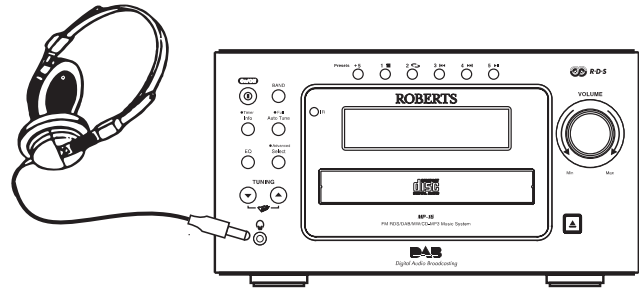

2. A digital optical output socket is provided on the rear of your radio for connection to a mini-disc recorder or other equipment with a digital optical input.

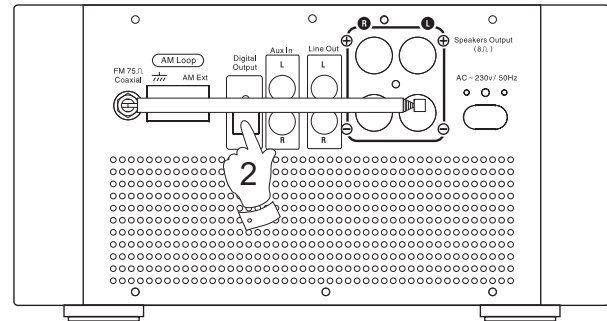

## Line-level input

1. Repeatedly press and release the **Band button** [Band/Source button on front panel] until "Aux" is displayed.
2. Connect an audio source (ie iPod, MP3 or CD player) to the **Aux in socket**. We strongly recommend that the unit is turned off when making connections to other equipment to avoid the possibility of unwanted loud noises from the loudspeakers or headphones.
3. You may need to adjust the **Volume control** on your iPod, MP3 or CD player for comfortable listening.

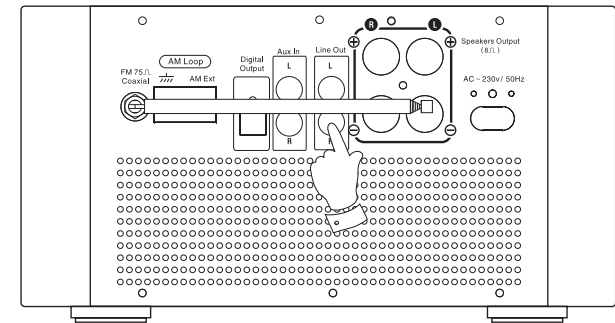
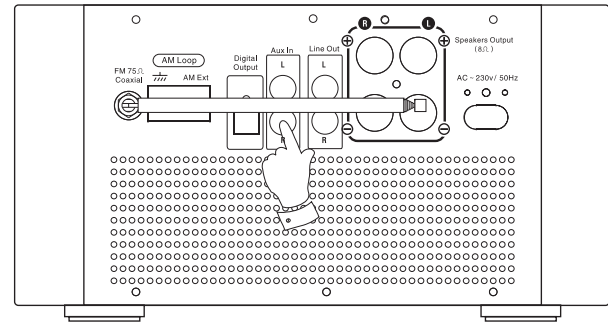

## Line-level output

A pair of line-level output sockets are located on the rear of your sound system are provided for connecting the audio signal to other equipment. The system will output an audio signal for whatever source is selected (see page 11).

## General

Do not allow this unit to be exposed to water, steam or sand. Do not leave your system where excessive heat could cause damage. For radio listening it is recommended that the DAB band be used wherever possible as better results in terms of quality and freedom from interference will usually be obtained than on the FM and MW band.

The name plate is located on the underside of the sound system.

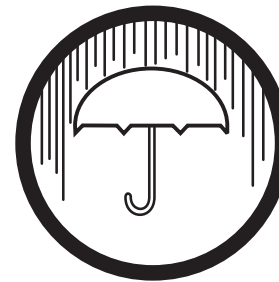
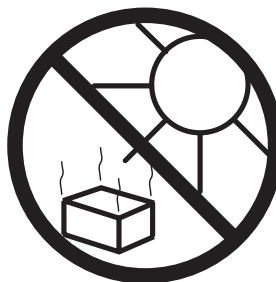

---

## Specifications

### Power Requirements

Mains	AC 230 volts, 50Hz  only
Battery (Remote control)	CR2025

### Frequency Coverage

FM	87.5-108MHz
MW	522 - 1620kHz
DAB	174.928 - 239.200MHz

## Circuit features

Loudspeaker	2 x 100 mm
Output Power	25 Watts RMS per channel
Headphone socket	3.5mm dia, stereo
Line in sockets	Dual phono
Line Out sockets	Dual phono
Digital optical output socket	Toslink
Aerial System	FM     Telescopic aerial
	MW     AM Loop antenna
	DAB    Telescopic aerial

The Company reserves the right to amend the specification without notice.

## Mains supply

The MP-16 will operate from a supply of AC 230 volts, 50Hz  only.

**DO NOT cut off the mains plug from this equipment.** If the plug fitted is not suitable for the power points in your home or the cable is too short to reach a power point, then obtain an appropriate safety approved extension lead or adaptor. If in doubt consult your dealer.

If nonetheless the mains plug is cut off, remove the fuse and dispose of the plug immediately to avoid a possible shock hazard by inadvertent connection to the mains supply.

If this product is not supplied with a mains plug, or one has to be fitted, then follow the instructions given below:

**IMPORTANT. DO NOT** make any connection to the larger terminal which is marked with the letter E or by the safety earth symbol  or coloured Green or Green-and-yellow.

The wires in the mains lead are coloured in accordance with the following codes :-

BLUE - NEUTRAL

BROWN - LIVE

The wire coloured BLUE must be connected to the terminal marked N or coloured BLACK.

The wire coloured BROWN must be connected to the terminal marked L or coloured RED.

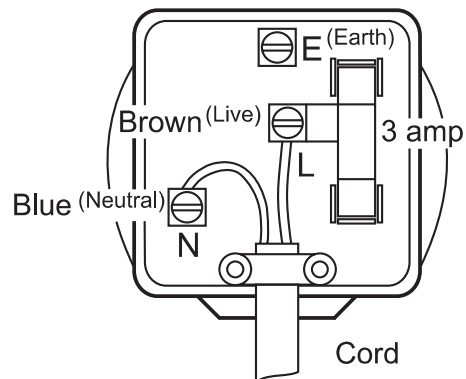

## Fuse

When replacing the fuse only a 3A ASTA approved to BS1362 type should be used and be sure to re-fit the fuse cover.

IF IN DOUBT - CONSULT A QUALIFIED ELECTRICIAN.

Replacement fuse holders are available from Roberts Radio Technical Services at the address shown on the rear of this manual.



## Notes

## Notes

## Guarantee

This instrument is guaranteed for twelve months from the date of delivery to the original owner against failure due to faulty workmanship or component breakdown, subject to the procedure stated below. Should any component or part fail during this guarantee period it will be repaired or replaced free of charge.

The guarantee does not cover:

1. Damage resulting from incorrect use.
2. Consequential damage.
3. Receivers with removed or defaced serial numbers.

N.B. Damaged or broken telescopic aerials will not be replaced under guarantee.

Procedure:

Any claim under this guarantee should be made through the dealer from whom the instrument was purchased. It is likely that your Roberts' dealer will be able to attend to any defect quickly and efficiently but should it be necessary the dealer will return the instrument to the Company's service department for attention. In the event that it is not possible to return the instrument to the Roberts' dealer from whom it was purchased, please contact Roberts Radio Technical Services at the address shown overleaf.

These statements do not affect the statutory rights of a consumer.



Issue 1

## **ROBERTS RADIO TECHNICAL SERVICES**

97-99 Worton Road

Isleworth Middlesex

TW7 6EG

Technical Helpline :- 020 8758 0338 (Mon-Fri during office hours)

Website: <http://www.robertsradio.co.uk>

